

2014 AUTOMATED CARRY CAN PRICE GUIDE

Name	Part Number	Description	List Price USD (\$)
Curotto-Can	SLMNEGL-01-B	Complete - Ready to Run	\$ 23,930
Curotto-Can 300 Gallon	SLMNEGL-01-300-HD-B	Curotto-Can for 300 Gallon can applications	\$ 25,281
Can Side Options			
Auto Cover	SE-RAC-CS-KT-INSTL	Rotary Auto Cover- Factory Installed on Container (need to complete kit by ordering through Body Original Equipment Manufacturer (OEM))	\$ 1,819
Brush Kit	SE-BK-XXX	Brush Kit/Hopper Seal- Factory Installed, Front, Curb & Streetside (need to complete kit by ordering through Body OEM)	\$ 540
Work Lamps	SE-WL-KT-NC	Work Lamp Kit, LED, Installed (need to complete kit by ordering through Body OEM)	\$ 1,238
Spacer Kit	EXT 9" Set	9-inch Spacer Required for Heil Installation	\$ 193
Gripper Arm	AC4-A001-4-UPGDE	Gripper Arm & Belt; 4 inches longer - per set	\$ 207
Conspicuity Tape	DOT-TAPE	Conspicuity Tape Installed, Front, Curb & Street Side	\$ 181
Truck Side Options			
Commercial Grabber*	CG-001KT	Commercial Gripper for picking up 32-96 gallon residential cans. *Complete Commercial Gripper clearance questionnaire and submit with order. Installation kit is an additional charge and will depend on the specific installation.	\$ 3,761

Effective May 20, 2014

Curotto-Can Commercial Gripper

The **Curotto-Can**
The Future of Automated Collection



Leverage your investment in a commercial front loader by adding the cost-saving Curotto-Can Commercial Gripper system.

The Curotto-Can Commercial Gripper enables a commercial front loader to grab, lift, and empty 32- to 96-gallon wheeled carts using either outside- or inside-the-cab controls. It is specially designed to lift heavy carts, such as those filled with green waste, food waste, or recyclables like crushed glass.

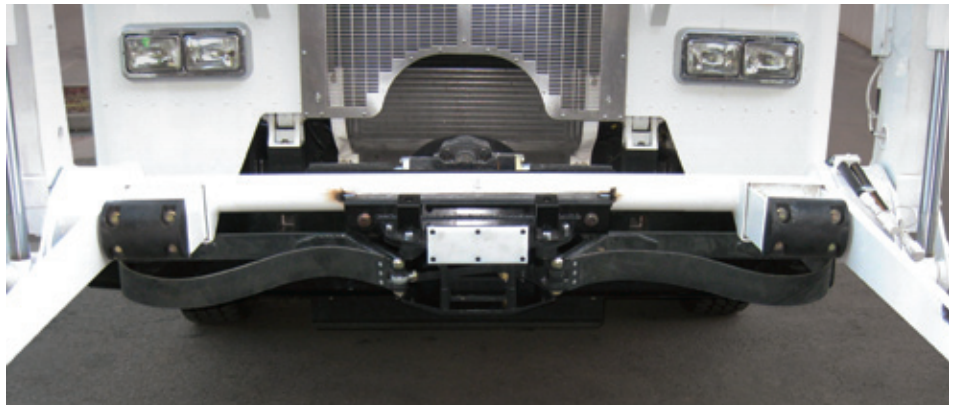

Key Features

- Eliminates the need for a second truck to pick up wheeled carts, which minimizes route duplication and reduces operating costs
- Provides the best gripper system for heavy carts without damaging cart bar pockets
- Positive lock system prevents carts from being lost in the hopper
- Mounted lower and forward on the fork tube to eliminate interference issues and protect the top of the packer blade and canopy from damage due to collision
- Route-proven technology means reliable performance
- Tucks out of the way when not in use to enable collection of commercial containers
- Patent pending

The Commercial Gripper can be ordered pre-installed on your front loader directly from the body manufacturer. For units already in service, a retro-fit installation kit is available.



**Environmental
Solutions Group**
A DOVER COMPANY

MOBILE LIFT SOLUTIONS

Technical Specifications

Dimensions	
Width	76.50 inches
Height at Center	10.75 inches
Depth at Center	12.75 inches
Weight	220 lbs.

Capacity	
Carts	32 to 96 gallons, wheeled
Lift Capacity	500 lbs.

Control System	
Inside or externally mounted curbside-accessible switch bank	

Hydraulic System	
Pressure	2000 psi
Supply	5 US gpm
Priority divider mounted to packer body. Flow divider is activated by container controls, not continuously activated.	

Cylinder	
Bore	1.50 inches
Stroke	7.00 inches
Shaft Diameter	1.00 inches
Induction-hardened, ground, and polished chromed rods	



Authorized Dealer:

Curotto-Can Commercial Gripper

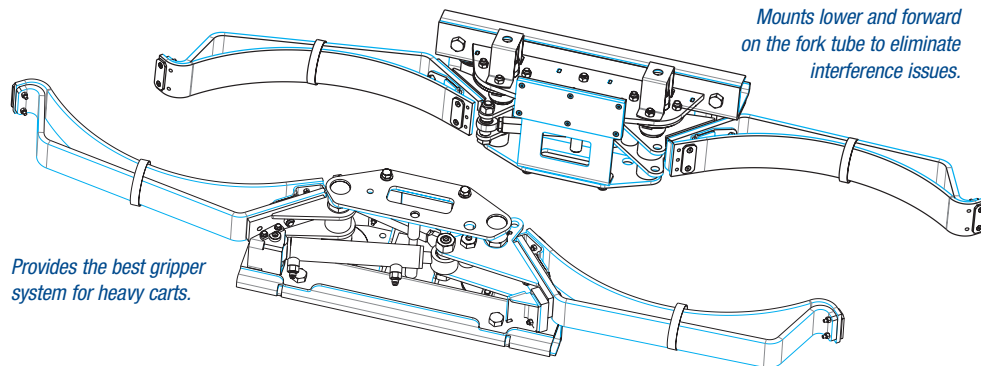

Mounts lower and forward on the fork tube to eliminate interference issues.

Provides the best gripper system for heavy carts.



Positive lock system prevents carts from being lost in the hopper.



The Curotto-Can
The Future of Automated Collection

The Curotto-Can, Inc.
2030 Hamilton Place Boulevard, Suite 200
Chattanooga, TN 37421
P: 707.939.2802 • F: 413.521.6644

© 2013 The Curotto-Can. All rights reserved. Curotto-Can is a registered trademark of The Curotto-Can Company. SWS-C00005-111513



**Environmental
Solutions Group**
A DOWER COMPANY

www.doveresg.com



Curotto-Can Automated Carry Can

The **Curotto-Can**
The Future of Automated Collection



The **Curotto-Can Automated Carry Can** has the fastest load time of any automated system on the market and delivers a proven 25% to 30% productivity advantage over automated side loaders.

By using the robust reliability of a front loader, this carry can delivers game-changing performance that will enable you to service more customers, more quickly, in more applications.



Key Features

- Fastest load time available — 4–5 seconds from wheel stop to wheel go
- 20% greater fuel efficiency due to less packing and idling
- Navigate cul-de-sacs up to 20% faster
- Eliminate cart loss and associated costs
- Eyes-forward operation reduces risks for repetitive stress injuries and enhances operator and public safety
- Reduce contamination rates to less than 5%
- Larger payload means fewer trips to the landfill or recycling center
- Load bulk material and eliminate the need for a chase truck
- Convert any commercial front loader to a residential collection unit in minutes



**Environmental
Solutions Group**

A DOVER COMPANY

P R O D U C T S H E E T

Technical Specifications

Dimensions	
Overall Size	55"H x 64"W x 81.75"L
Inside Height	45.88"
Lifting Pocket	6"H x 3"W x 0.25" thick high-strength steel
Weight	1680 lbs.

Capacity	
Carts	32 to 96 gal.
Lift Capacity	500 lbs.
Volume	4.6 cu. yd.

Cycle Times at 14 gpm	
Full Slide Extend	2.5 seconds
Full Slide Retract	1.5 seconds
Dump	2.0 seconds
Dump Return	1.2 seconds

Control System	
Externally mounted curbside and/or streetside joystick-type cab; optional curbside-accessible switch bank mounts to cab interior	

Hydraulic System	
Pressure	2000 psi

Cylinders	
Slide	
Bore	1.5"
Stroke	54"
Shaft Diameter	1"
Dump	
Bore	2.5"
Stroke	14"
Shaft Diameter	1.5"
Grab Cylinder	
Bore	1.5"
Stroke	7"
Shaft Diameter	1"
Induction-hardened, ground, and polished chrome rods	

Curotto-Can Automated Carry Can

With this versatile system, you can replace an automated side loader, recycling unit, or a rear loader with cart tipper to cost effectively reduce the number of units in your fleet.

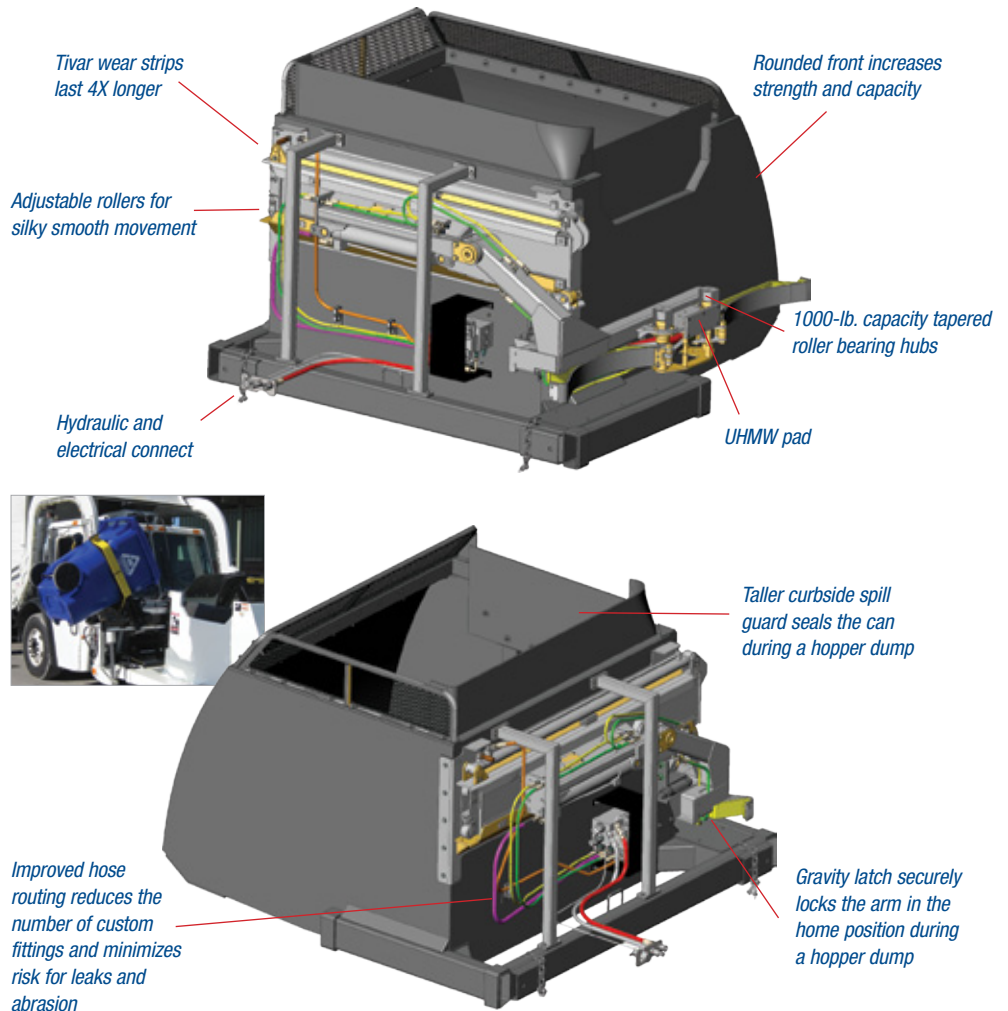

To learn how to make your route more productive and significantly reduce your overall costs, call us today at **707.939.2802!**

Authorized Dealer:

The Curotto-Can
The Future of Automated Collection

The Curotto-Can, Inc.
2030 Hamilton Place Boulevard, Suite 200
Chattanooga, TN 37421
P: 707.939.2802 • F: 413.521.6644



Environmental Solutions Group
A DOWER COMPANY

www.doveresg.com

